

# Blu'Hox™

## User's Guide



**ROXELL®**

## TABLE OF CONTENTS

TABLE OF CONTENTS	
DISCLAIMER	
GENERAL INFORMATION	
OPERATOR'S GUIDE .....	1
ROTOR ADJUSTMENT .....	3
TROUBLE SHOOTING GUIDE .....	4

**DISCLAIMER** : The original, authoritative version of this manual is the English version produced by ROXELL bvba. Subsequent changes to any manual made by any third party have not been reviewed nor authenticated by Roxell. Such changes may include, but are not limited to, translation into languages other than English, and additions to or deletions from the original content. Roxell disclaims responsibility for any and all damages, injuries, warranty claims and/or any other claims associated with such changes, inasmuch as such changes result in content that is different from the authoritative Roxell-published English version of the manual. For current product installation and operation information, please contact the customer service and/or technical service departments of Roxell. Should you observe any questionable content in any manual, please notify Roxell immediately in writing to: ROXELL bvba - Industrielaan 13, 9990 Maldegem - Belgium.

## GENERAL INFORMATION

**THESE INSTRUCTIONS MUST BE READ, UNDERSTOOD AND ALL POINTS OBSERVED BY THE USER, THE RESPONSIBLE AND OPERATING PERSONNEL.**

### 1. OBEY THE LEGAL REGULATIONS AND THE APPLICABLE RULES!

This concerns, among other things, the European directives transposed into national legislation and/or the laws, safety and accident prevention regulations that apply in the user's country.

During assembly, operation and maintenance of the installation the legal regulations concerned and the applicable technical rules must be obeyed.

### 2. INTENDED USE

The installation has been designed solely for intensive livestock use and has been developed according to the applicable rules of good workmanship. Extra loading of the product is therefore prohibited. Any other use is considered to be improper use. The manufacturer is not responsible for damage resulting there from. The user bears sole responsibility.

### 3. NOT-INTENDED USE

All use different than described in point 2" intended use" is at the responsibility of the end user.

### 4. LIABILITY

The (Extended) Warranty will not apply if any of the following has occurred: failure to conduct incoming goods inspection with regards to the Products, improper handling, transportation, modification or repair; accident, abuse or improper use; improper assembly, installation, connection or maintenance (having regard to Roxell's most current assembly, installation, connection and maintenance manuals); force majeure; negligence, lack of supervision or of maintenance on the part of customer; normal wear and tear; use of cleansing agents and disinfectants that are excluded in Roxell's most current use and maintenance manuals; use of cleansing agents and disinfectants in violation with the instructions received from the suppliers; or use of the Products in an ATEX-surrounding.

The (Extended) Warranty shall not apply in the event of a defect caused either by materials or accessories supplied by or services rendered by Customer; or by an intervention by a person or entity which is not authorised or qualified for carrying out such intervention. Furthermore, the (Extended) Warranty will only apply if the Products are used in livestock houses and if all parts or components of the Products are supplied by Roxell.

Roxell will not be liable for any damages caused due to improper use, assembly, installation, connection or maintenance of the Products. In this respect, the Customer expressly acknowledges that (i) all use, assembly, installation, connection or maintenance must be done in accordance with Roxell's most current assembly, installation, connection and maintenance manuals and (ii) the electrical installation on which the Products must be connected must be done in accordance with applicable local legislation on electrical installations. Furthermore, the Products must be tested both mechanically and electrically in accordance with state of the art techniques and applicable local legislation.

### 5. PERSONNEL QUALIFICATIONS

#### USER:

The person who uses a function or operation of a product for their work or who works on the product. The user must be able to read the instructions for use and fully understand them. The user has knowledge of the functioning and construction of the installation.

#### TECHNICALLY TRAINED PERSON:





An expert who can assemble and maintain the installation (**mechanically/electrically**), and resolve malfunctions. On the basis of his/her technical training and experience, he/she has sufficient knowledge to be able to assess activities, recognise possible dangers and rectify dangerous situations.

## 6. INFORMATION ABOUT THE RESIDUAL RISKS - USED SAFETY SIGNS

There are three levels of danger, which you can recognize from the signal word

- \* **DANGER**
- \* **WARNING**
- \* **CAUTION**

The nature and source of the imminent danger and possible consequences of not obeying warnings is stated here!

 <b>DANGER</b>	<p><b>DANGER</b> indicates a direct imminent danger that can result in a serious or even fatal accident if the safety measures are not respected.</p>
 <b>WARNING</b>	<p><b>WARNING</b> indicates a possible imminent danger that can result in a serious accident or damage to the product if the safety measures are not respected.</p>
 <b>CAUTION</b>	<p><b>CAUTION</b> indicates possible, dangerous situations that can result in minor physical injury or material damage if the safety measures are not respected.</p>
	<p>This symbol refers to supporting information.</p>
<p> <input checked="" type="checkbox"/> allowed  <input type="checkbox"/> not allowed         </p>	

## 7. STORAGE

Put all parts to be assembled in a room or at a location where the not yet assembled components are protected against weather influences.

## 8. TRANSPORT

Depending on the size of the parts and according to local circumstances and local legislation, the parts of the machine have to be transported with a forklift.

The forklift must be operated by a qualified person and in accordance with the rules of good workmanship.

When lifting the load, always check if the center of gravity of the load is stable.

## 9. DISMANTLING

Dismantle the installation and its components in accordance with the environmental legislation of the country or the local authorities applicable at that time. All functioning products and exchange parts must be stored and disposed of in accordance with the applicable environmental regulations.

### Environmental information for customers in the European Union



European directive 2002/96/EC amended by the Directive 2008/34/EC requires that equipment that bears this symbol on the product or packaging must not be disposed of with unsorted household waste. This symbol indicates that the product must be disposed of separately. You are yourself responsible for the destruction of this and other electrical and electronic equipment via the disposal channels designated for that purpose by the national or local government. The correct destruction and recycling of this equipment prevents any negative consequences for the environment and health. For more information about destroying your old equipment, contact your local authorities or waste disposal service.

### Information about waste disposal - electrical/electronic material for companies

#### 1. In the European Union

If you have used the product for commercial purposes and you want to dispose of it, contact Roxell who will give you information about the return of the product. It is possible that you will have to pay a disposal charge for the return and recycling. Small products (and small quantities) can be processed by the local collection agencies.

#### 2. In other countries outside the European Union

If you want to dispose of this product, contact the local authorities for information concerning the correct disposal procedure.

## 10. THE LEVEL OF NOISE EMISSION

The noise level of the installation in operation does not exceed 70dB(A).

## 11. LOCK OUT TAG OUT – LOCK METHOD GENERAL

- Everyone needs his own lock and tag (label), which can't be removed by other persons.
- Inform all persons who are influenced by the procedure.
- Localize all sources of energy (electric, hydraulic, pneumatic).
- Switch off.
- Lock out and tag out.
- Check if the source of energy is switched off.
- Remove any remaining energy.

## 12. USE PERSONAL PROTECTIVE EQUIPMENT.

Ensure you wear personal protective equipment (gloves, dust masks...).

## 13. SUFFICIENT LIGHTING - ILLUMINANCE

- **A minimum illuminance of 200 lux is necessary** during usage, maintenance and installation.
- Provide at the installation **(portable) emergency lighting in case of power failure.**

## 14. ELECTRICAL EQUIPMENT, CONTROL PANELS, COMPONENTS AND DRIVE UNITS

- To operate control panels, there must be **at least 70 cm of free space.**
- Control panels must **always remain closed.** The key of the control panel must be in possession of an authorized person.
- The necessary measures must be taken by the user to keep out **rats, mice and other vermin from the control panels**
- If electrical equipment, control panels, components and drive units are damaged, the system must be stopped **IMMEDIATELY!**
- Electrical equipment, control panels, components and drive units should **NEVER be sprayed with water or other liquid!**
- Electrical equipment, control panels, components and drive units should **NEVER be covered with any material.**

### 1. POSITION OF THE HANDLE/ROTOR OPENING

**POSITION 0:**  
NO FEED / CLOSED

**POSITION 20:**  
MAXIMUM FEED / CLEANING

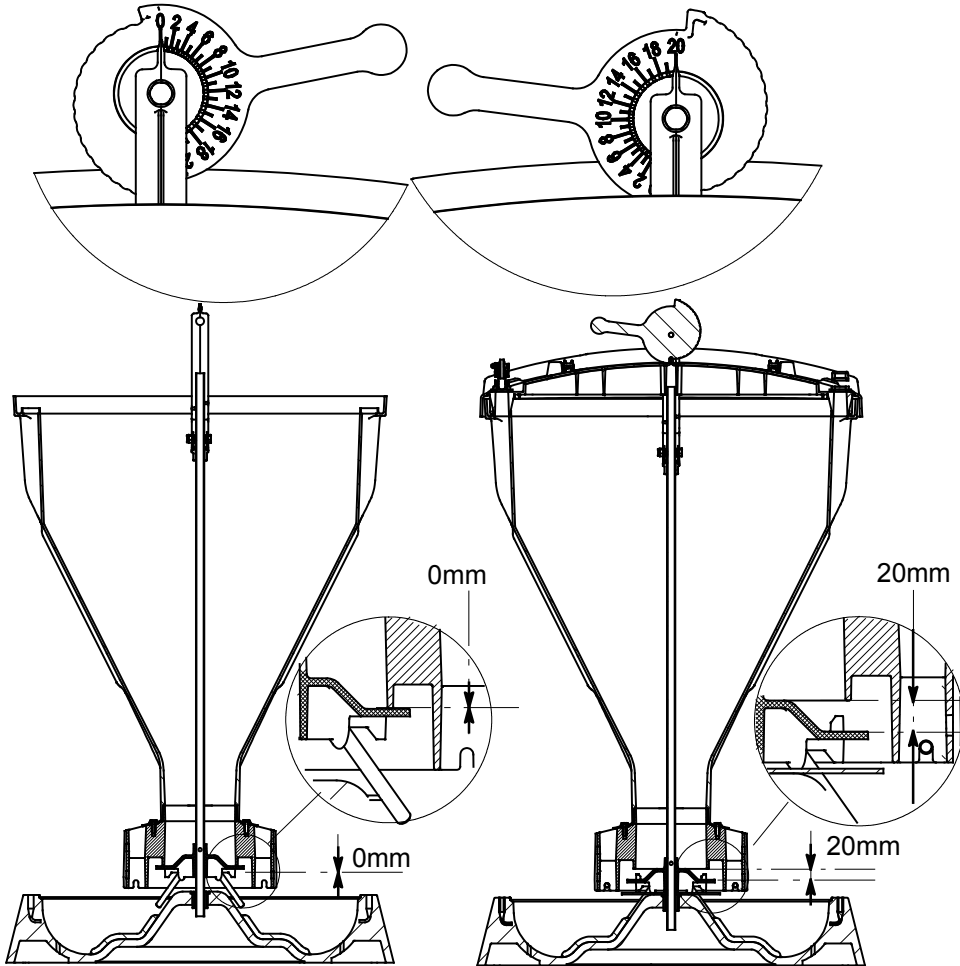

### 2. TO SET THE AMOUNT OF FEED

**TIP : MEAL :**  
 LESS FLOWING FEED = POSITION MORE THAN 12  
 EASY FLOWING FEED (I.E CRUMBLES) = POSITION LOWER THAN 10  
 PELLETS : Ø PELLET + 2 POSITIONS  
 NURSERY : START POSITION 12

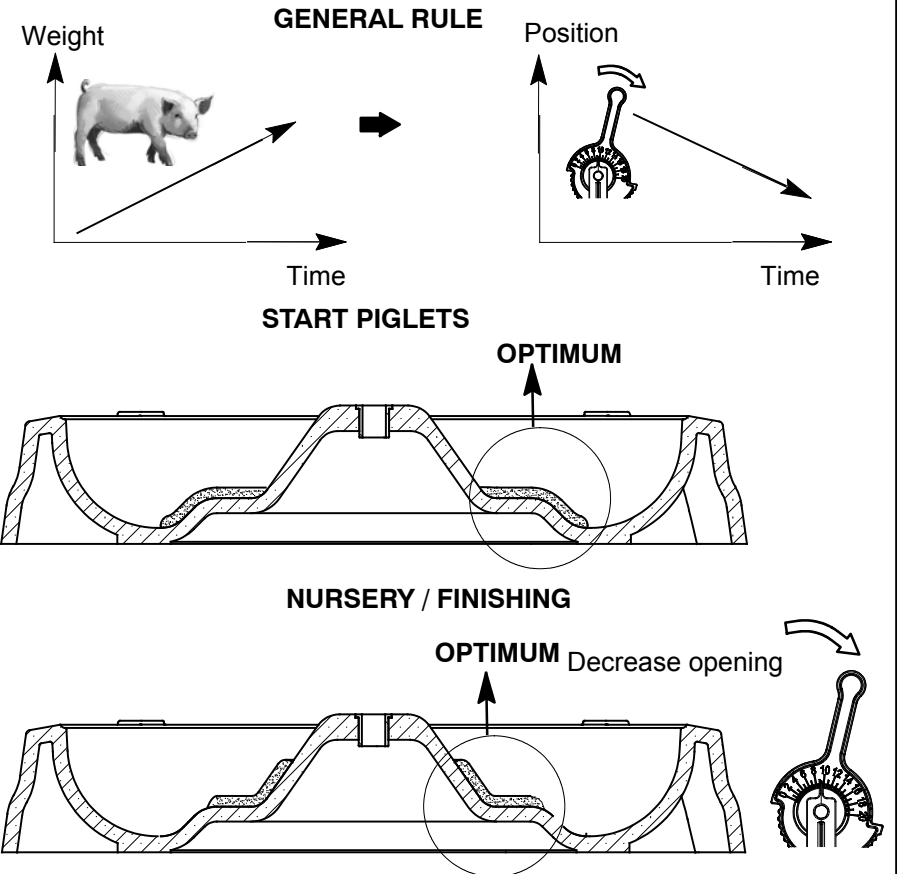

### 3. WATER SUPPLY

#### NIPPLE NURSERY

**14207559**

**RECOMMENDED**

5 kg --> 30 kg ± 400 - 500 ml/min

#### NIPPLE FINISHING

**14301832**

**RECOMMENDED**

20 kg --> 120 kg ± 700 - 1000 ml/min

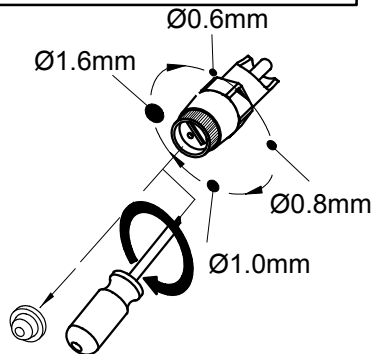

Ø	PRESSURE WATER INLET			
	0.3 Bar	1 Bar	2 Bar	3 Bar
• 0.6mm	190	340	420	470
• 0.8mm	250	500	700	810
• 1.0mm	400	700	950	1100
• 1.6mm	800	1400	1900	2200

Water flow in ml/min

\* Factory setting

Ø	PRESSURE WATER INLET			
	0.5 Bar	1 Bar	2 Bar	3 Bar
0.6mm	320	400	600	800
0.8mm (*)	500	660	900	1200
1.0mm	700	780	1140	1600
1.6mm	1120	1640	2600	3000

Water flow in ml/min

\* Factory setting

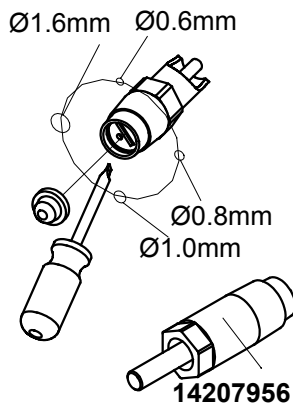

### 4. CLEANING

**Tip: moisten before cleaning (soak)**

**CLEANING POSITION 20:**

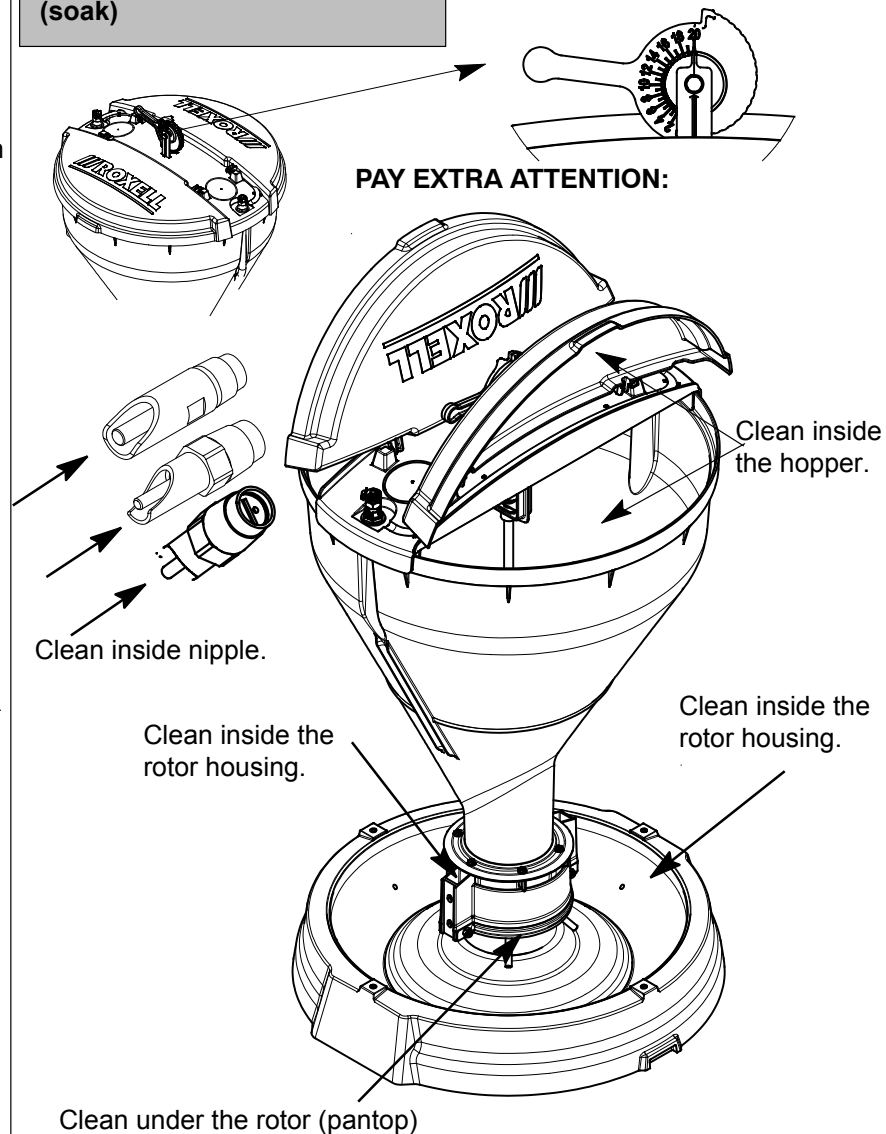



## ROTOR ADJUSTMENT

Position the handle on "0"

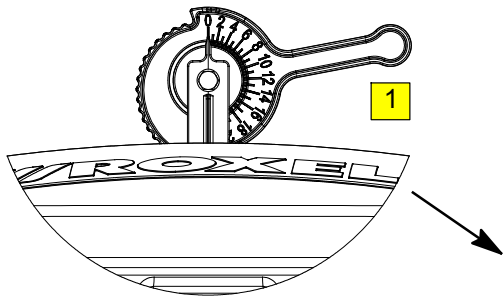

FIGURE 1.



**2** Loosen the clamp :  
loosen bolt and nut.

**5** Secure the clamp:  
tighten bolt and nut.

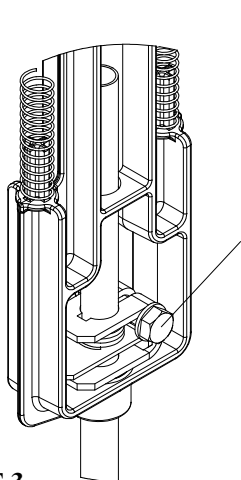
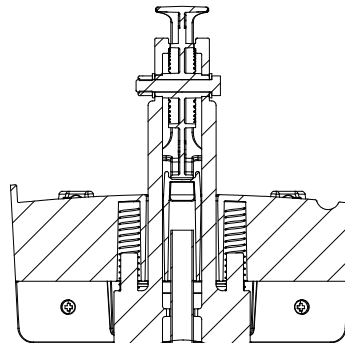

FIGURE 3.

**3** Close the rotor disc manually :



Pull and hold the  
adjustment  
tube upwards,  
and...

...push at the same time.

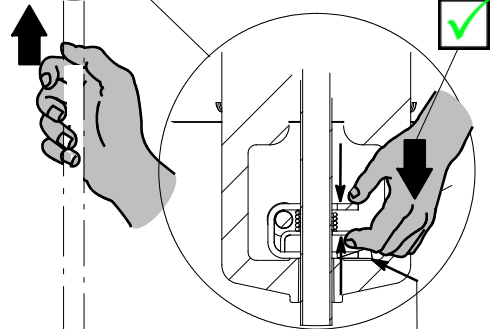

No clearance.

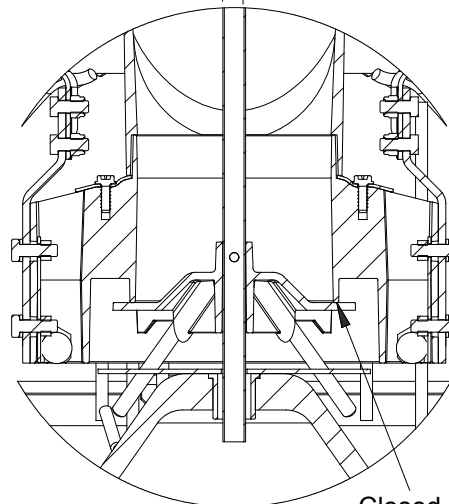

FIGURE 2.



## TROUBLE SHOOTING GUIDE



**DANGER**

**Switch off the main switch first.  
Use personal protective equipment.**

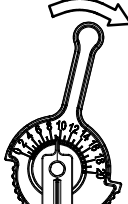
**ACTIONS IN GREY BACKGROUND MUST BE DONE BY A TECHNICALLY TRAINED PERSON.**

PROBLEM	CAUSE	CORRECTIVE ACTION
1. Blu'Hox does not shut off in position 0.	- Rotor adjustment not correct.	- Re-adjust rotor. See "ROTOR ADJUSTMENT".
2. Feed level in pan is too high.	- Blu'Hox feed adjusted too high.	- Decrease opening. See operator's guide: "TO SET THE AMOUNT OF FEED". 
3. No feed or not enough feed in pan.	- Blu'Hox feed adjusted too low.	- Increase opening. See operator's guide: "TO SET THE AMOUNT OF FEED". 
4. Leaking nipples.	- Trash in the nipple. - Joint worn out.	- Clean the nipple. - Replace sealing material.
5. No water at nipples.	- Filter in pan inlet choked. - Water control panel does not work. - Air in pipes. - Opening flow control in nipple disc choked. - Filter in nipple choked.	- Clean the filter. - Clean the filter cartridge. Check hand cock. - Aerate well. - Clean disc in nipple housing. - Unmount nipple and clean filter.
6. Too low capacity at nipples.	- Insufficient water pressure.	- Provide sufficient water pressure.
	- Nipple not correctly adjusted. - Main water supply choked. - Opening flow control in nipple disc choked. - Filter in nipple choked.	- Adjust nipple at a larger opening. - Clean main water supply pipes. - Clean disc in nipple housing. - Unmount nipple and clean filter.
7. Too large capacity at nipples.	- Pressure not adjusted. - Nipple not correctly adjusted.	- Adjust water pressure. - Adjust nipple at a smaller opening.
8. Too much water in the pan.	- See operator's guide: "WATER SUPPLY".	- See operator's guide: "WATER SUPPLY".
9. Blu'Hox feed adjustment cannot be opened widely.	- Feed under feed disc.	- Clean under the feed disc ! See operator's guide: "CLEANING".

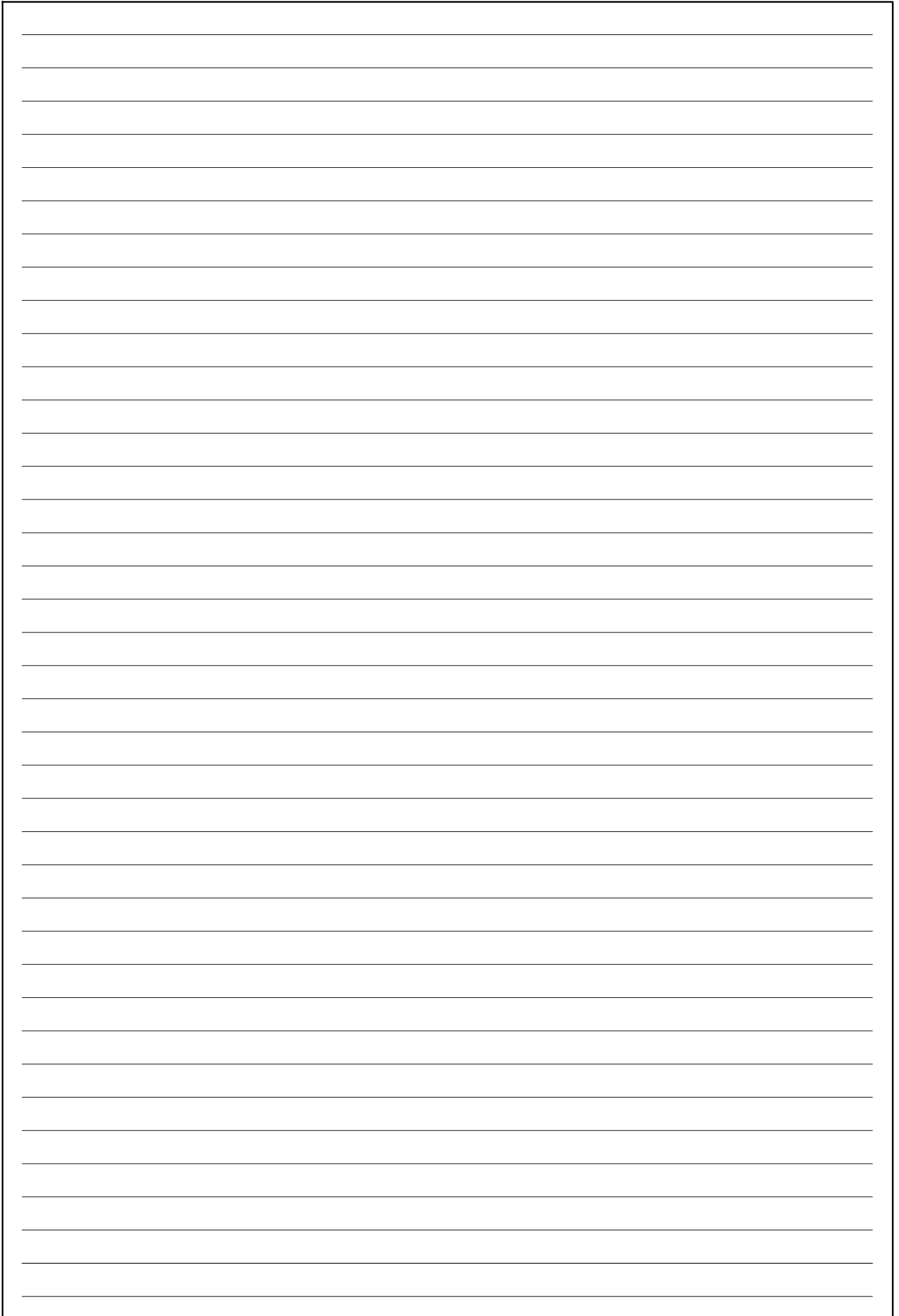



ROXELL bvba, Industrielaan 13, B-9990 Maldegem (Belgium)  
Tel. +32 50 72.91.72 - Fax. +32 50 71.67.21 - e-mail: [info@roxell.com](mailto:info@roxell.com) - [www.roxell.com](http://www.roxell.com)

ROXELL USA, Inc. - 720 Industrial Park Road - Anderson, MO 64831 (USA)  
Phone +1 417 845-6065 - Fax. +1 417 845-6069 - e-mail: [info.usa@roxell.com](mailto:info.usa@roxell.com) - [www.roxell.com](http://www.roxell.com)

ROXELL Malaysia - No. 12 Jalan Anggerik Mokara31/48, Kota Kemuning - Industrial Park, 40150 Shah Alam, Selangor,  
Malaysia - Tel: +603 5121 7148 or +603 5121 7150 - Fax: +603 5121 7146 - A division of CTB Malaysia Sdn. Bhd.  
(868715-X) - e-mail: [info.malaysia@roxell.com](mailto:info.malaysia@roxell.com) - [www.roxell.com](http://www.roxell.com)

ROXELL Россия - ООО «Рокселл» ОГРН 1157746055026, 125167, Россия, г. Москва,  
Ленинградский проспект, д. 37, корп. 9, пом. 653  
Телефон: +7 (495) 983-30-15 Факс: +7 (495) 983-30-15 - Эл. адрес: [info.russia@roxell.com](mailto:info.russia@roxell.com) - [www.roxell.com](http://www.roxell.com)